



1730 N. BRADSHAW AVE.
PROVIDENCE, RI 02904
508.262.5900

CLIENT NAME
CLAYCO

PROJECT TITLE
Extruded for Three
Versions

CLIENT CONTACT
Steven Felt
12401-10, Exton
Steven.Felt@clayco.com
610.271.2900

PROJECT ADDRESS
Newark
12401-10, Exton
12401-10, Exton
12401-10, Exton

SG PROJECTTEAM
Account Manager:
Alexa Reinhardt
Interior Designer:
Cristina Hill

ALTERNATIVE
ALT. INDATE

REVISION LOG

1. AVALON 03
- 2.
- 3.
- 4.
- 5.
- 6.
- 7.
- 8.
- 9.
- 10.

This set of drawings contains the final design for the project and is to be used for construction only. It is not to be used for any other purpose. All rights reserved. No part of this drawing may be reproduced or transmitted in any form or by any means, electronic or mechanical, including photocopying, recording, or by any information storage and retrieval system, without the prior written permission of the architect.

CRAWFORD HALL

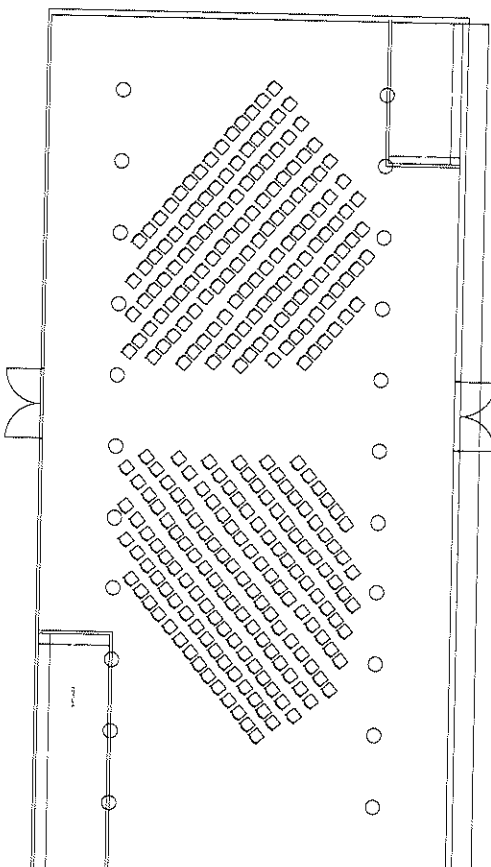
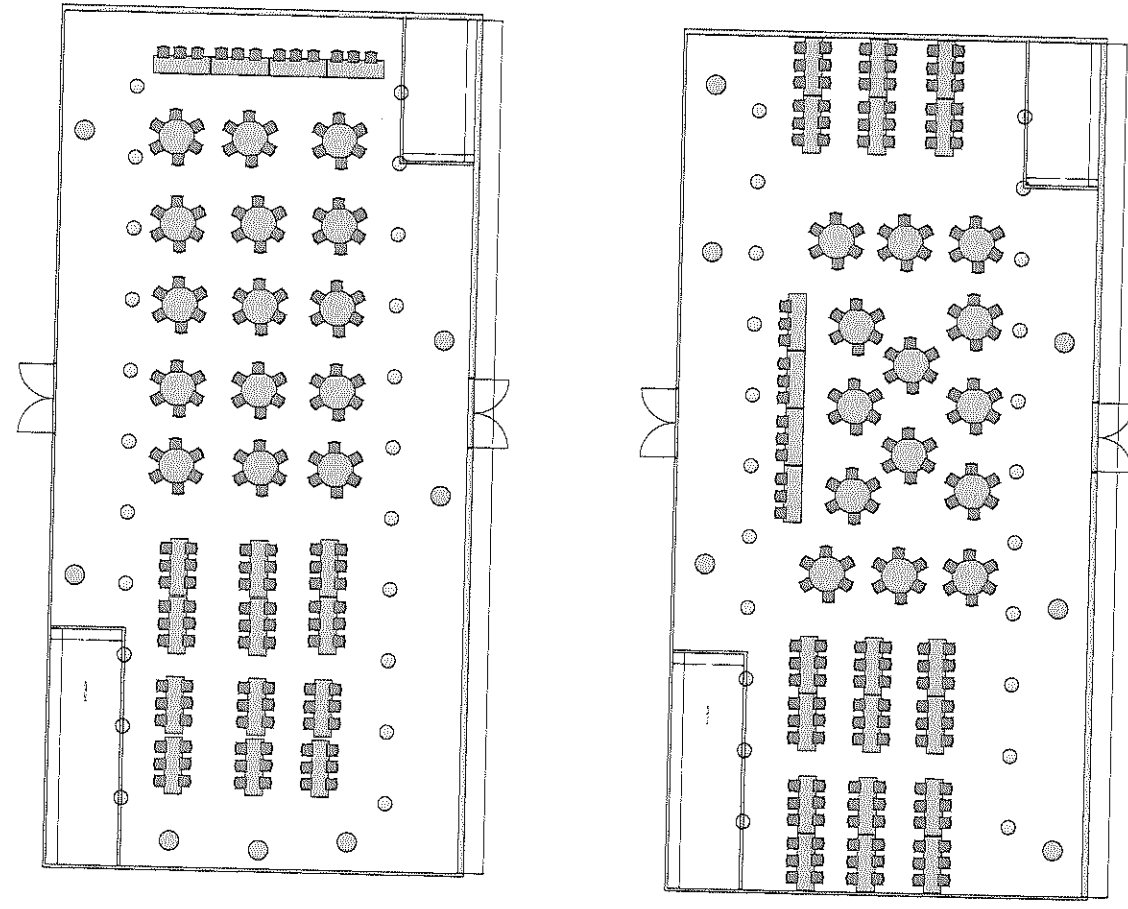

Crawford

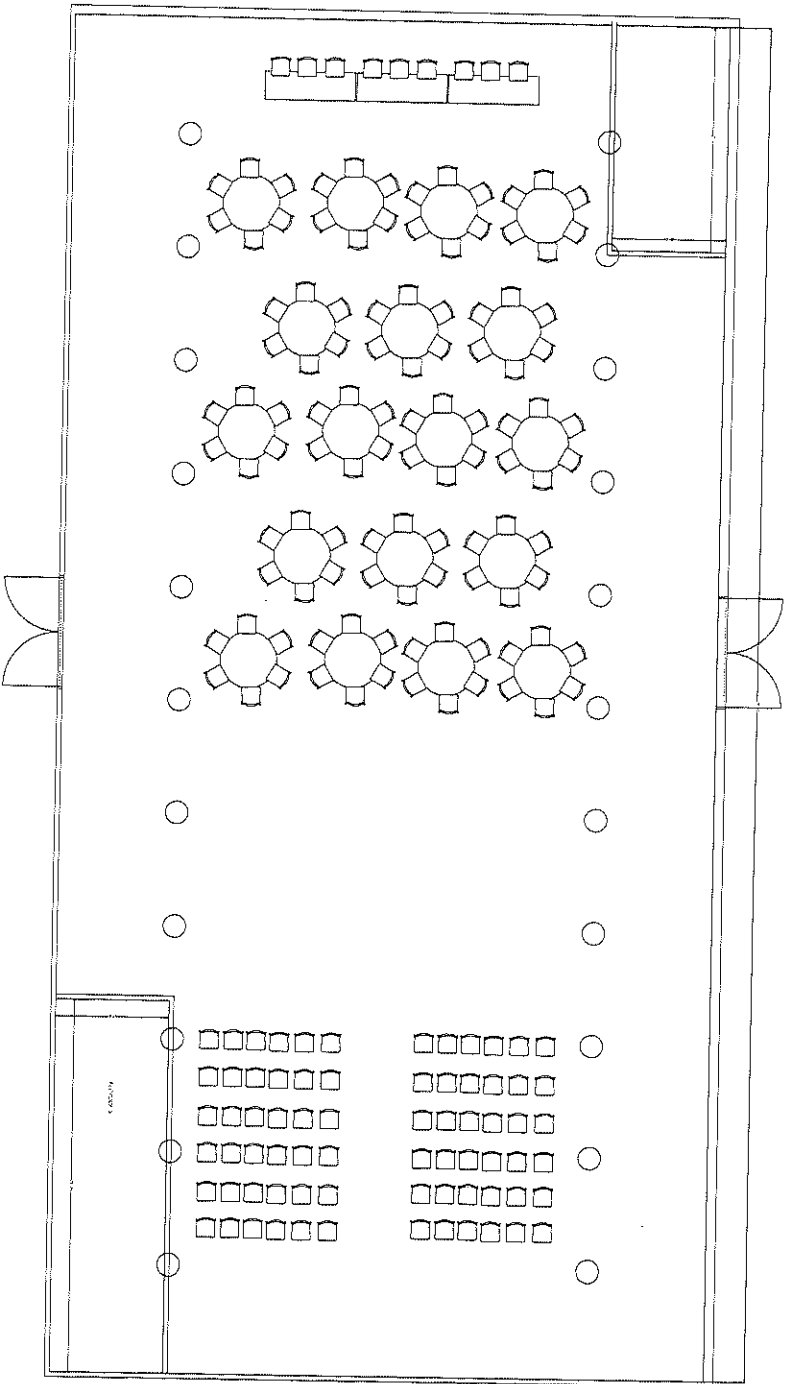

**schmidt
goodman**
office products, Inc.

17281 N. Evergreen Way
Richardson, TX 75081
507.282.8570

CLIENT NAME
OLMCO

PROJECT TITLE
Layouts for Three
Venues

CLIENT CONTACT
Steven Firdi

Steven.Firdi@olmco.com
olmco.gov

PROJECT ADDRESS
Koch Center

SG PROJECT TEAM
Account Manager:
ALYSA WOODS/MLD/MLD
Interior Designer:
CHRISTINA HILL

ALTERNATIVE
ALT NAME

REVISION LOG

NO.	DATE	DESCRIPTION
1	11/11/11	ISSUE
2	11/11/11	ISSUE
3	11/11/11	ISSUE
4	11/11/11	ISSUE
5	11/11/11	ISSUE

This document contains information considered proprietary to SCOP and is provided for use only in work to be performed for SCOP and shall not be used or reproduced or communicated in whole or in part to third parties without the written permission of SCOP.

Crawford

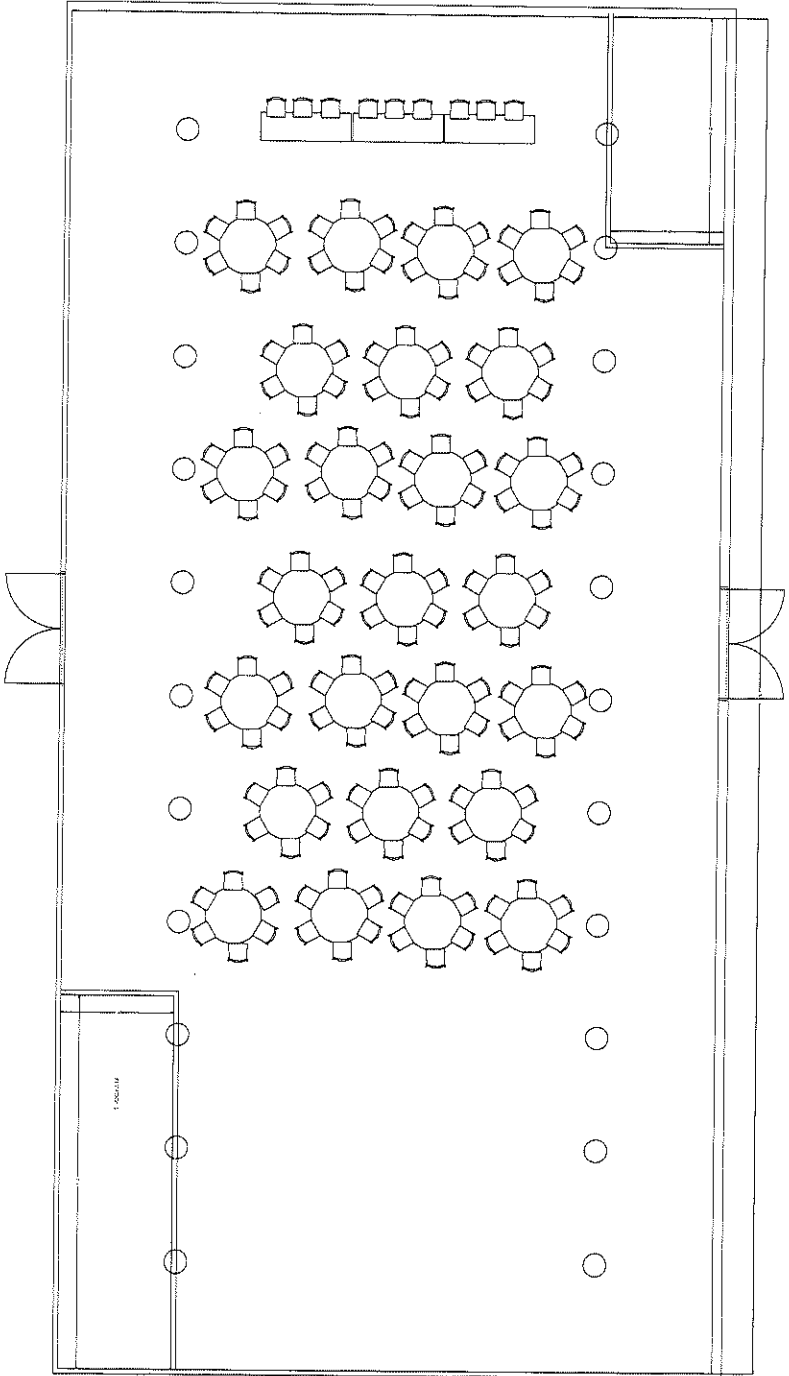

**schmidt
goodman**
office products, inc.

1720 N. Broadway Ave.
Rochester, NY 14616
507.282.3570

CLIENT NAME
OLMCO

PROJECT TITLE
Layouts for Break
Venues

CLIENT CONTACT
Steven Fitch

Stevend.fitch@olmco.com
Unit: 490V

PROJECT ADDRESS
Rochester

SG PROJECT TEAM

Account Manager:
AMY WOODS/SGP/SGP
Interior Designer:
C. COSSAR/SGP/PHD

ALTERNATIVE

ALT. NAME

REVISION LOG

REV. NO.	DATE	DESCRIPTION
1	1/24/2023	Initial
2	1/24/2023	Revised
3	1/24/2023	Revised
4	1/24/2023	Revised
5	1/24/2023	Revised

This document contains information considered proprietary to SGCP, and is provided for use only in work to be performed by SGCP and shall not be used or reproduced or communicated in whole or in part to third parties without the written permission of SGCP.

Crawford

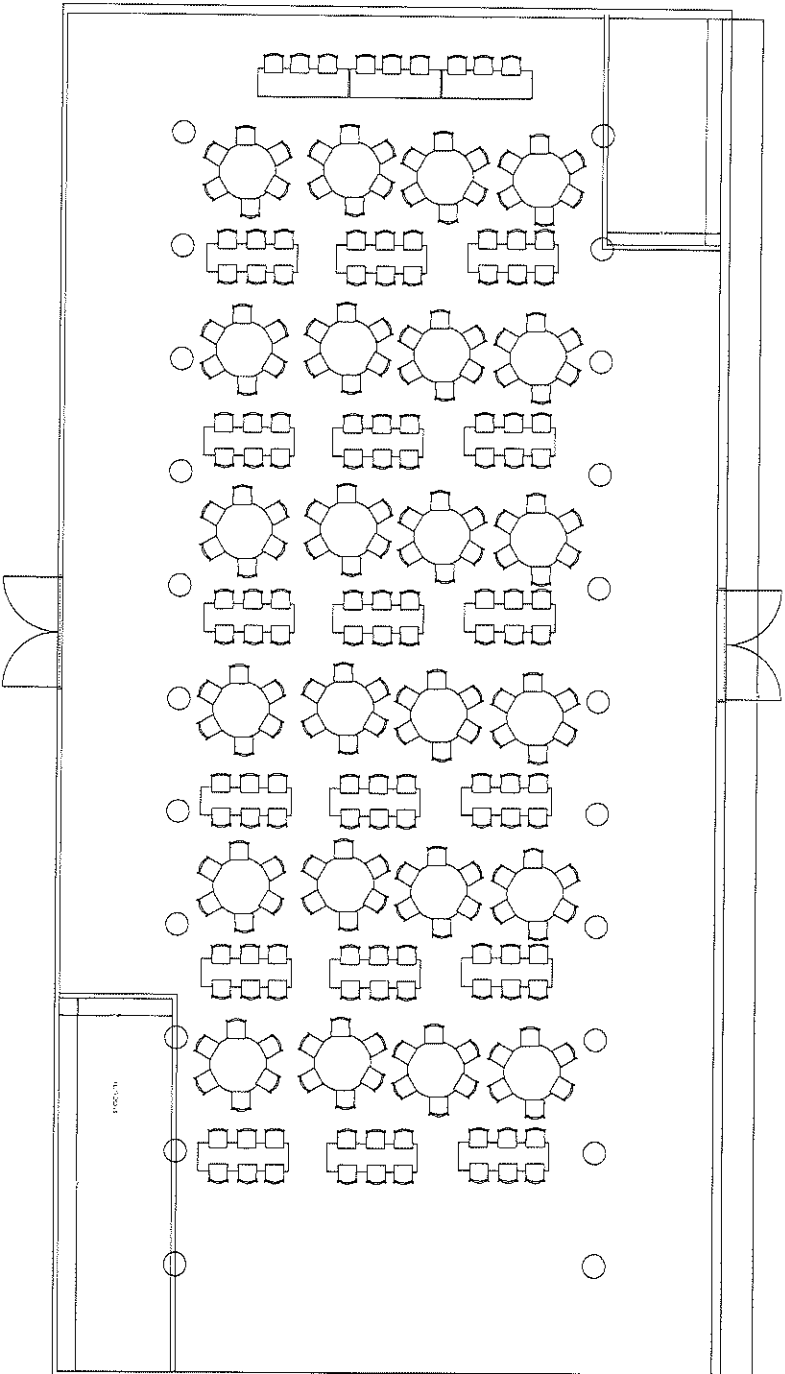

**schmidt
goodman**
office products, Inc.
1720 N. Rockway Ave.
Richardson, TX 75086
972.287.2670

CLIENT NAME
OLMCO

PROJECT TITLE
Layouts for three
venues

CLIENT CONTACT
Steven Finn

steven.finn@olmco.com
olmco.com

PROJECT ADDRESS
Richardson

SG PROJECT TEAM
Account Manager:
ALISA WUNDERLIEB
Interior Designer:
CORSANDEA HILL

ALTERNATIVE
ALL NAME

REVISION LOG

NO.	DATE	BY	DESCRIPTION
1	11/11/2023	AL	Initial
2	11/11/2023	AL	Initial
3	11/11/2023	AL	Initial
4	11/11/2023	AL	Initial
5	11/11/2023	AL	Initial

This document contains information considered proprietary to SGPF, and is provided for use only in work to be performed for SGPF and shall not be used or reproduced or communicated in whole or in part to third parties without the written permission of SGPF.

Crawford

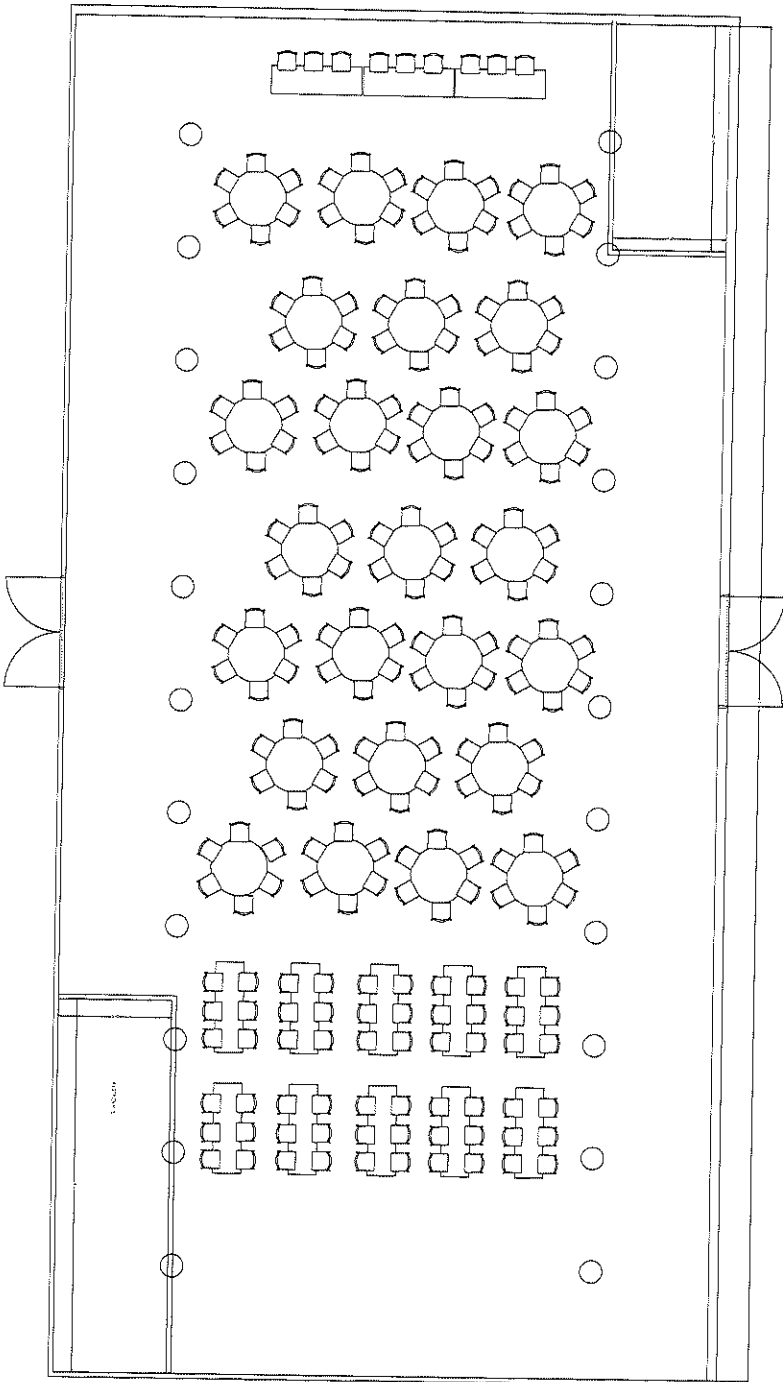

**schmidt
goodman**
office products, inc.

1926 N. Dixon Road, Suite 400
Evanston, IL 60201
312.282.8670

CLIENT NAME

OLMCO

PROJECT TITLE

LAYOUTS FOR THREE
VENUES

CLIENT CONTACT

STEVEN FINE

1170 N. DIXON ROAD
EVANSTON, IL 60201

PROJECT ADDRESS

RECHARDER

SG PROJECT TEAM

Account Manager:
ALYSA WUNDERLINDER

Interior Designer:
CASSANDRA HEIL

ALTERNATIVE

ALL NAME

REVISION LOG

NO.	DATE	BY	DESCRIPTION
1	11/11/11	AS	ISSUE
2	11/11/11	AS	ISSUE
3	11/11/11	AS	ISSUE
4	11/11/11	AS	ISSUE
5	11/11/11	AS	ISSUE

This document contains information considered proprietary to SGDP, and its use or reproduction for any other purpose without the written permission of SGDP is prohibited.

Crawford

Example of 8 Chairs

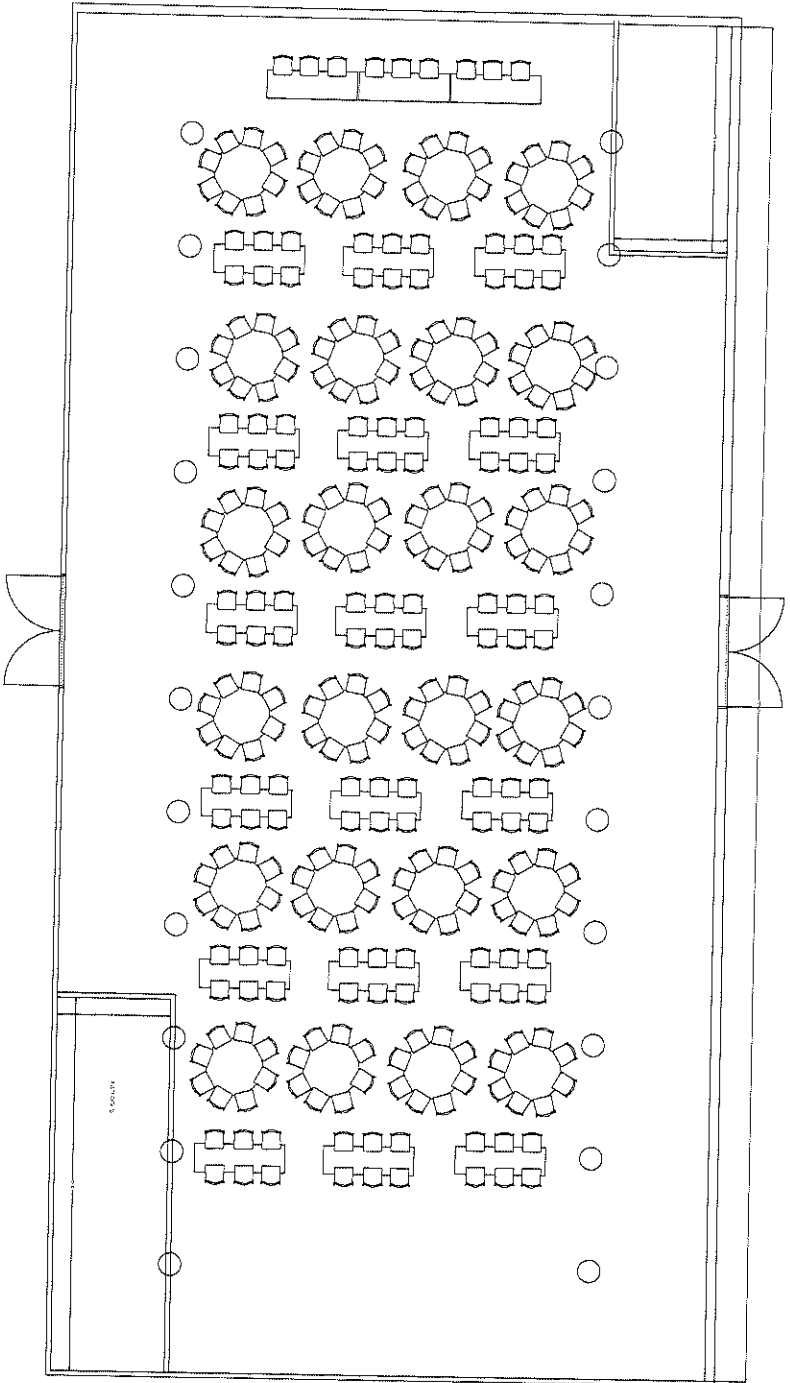

**schmidt
goodman**
office products, inc.
1720 N. BROOKVIEW AVE
RICHMOND, VA 23206
507.292.8970

CLIENT NAME
CLINCO

PROJECT TITLE
Layouts for Three
Venues

CLIENT CONTACT
Steven Field
Steven.Field@schmidtco
unity.com

PROJECT ADDRESS
New Market

SG PROJECT TEAM
Account Manager:
Alysa Wronskinder
Interior Designer:
Cassandra Heff

ALTERNATIVE
ALL NAME

REVISION LOG

NO.	DATE	DESCRIPTION
1.	11/12/2023	1.
2.		2.
3.		3.
4.		4.
5.		5.