

FLORAL HALL

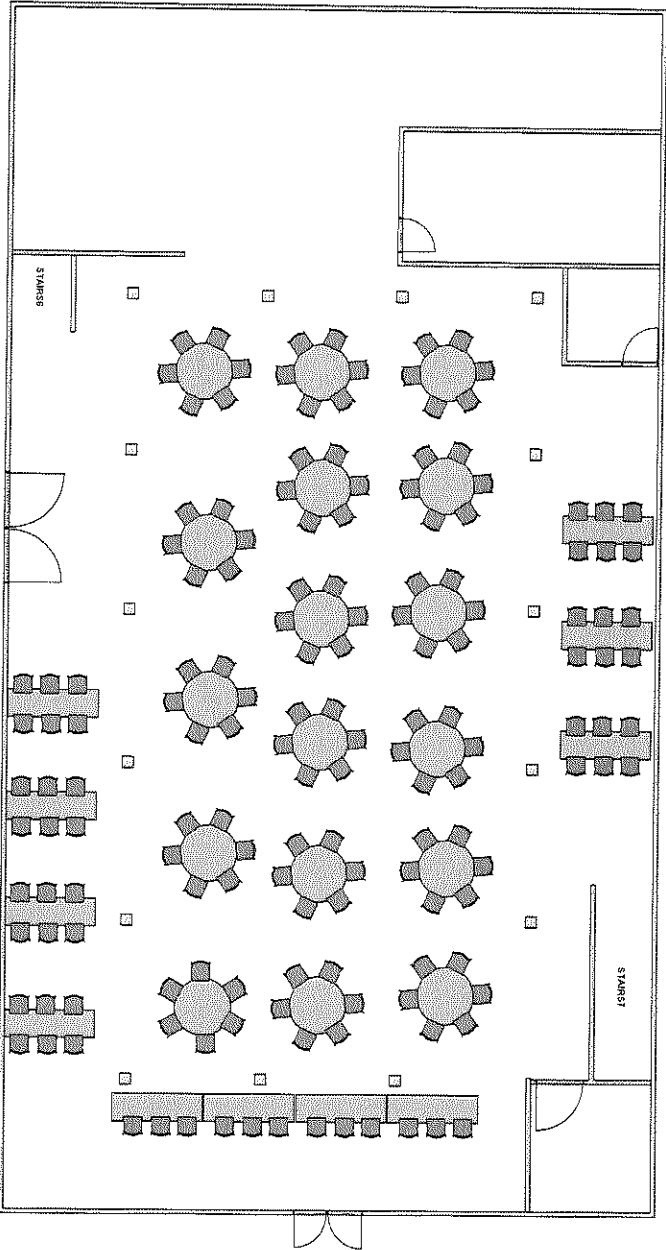

**schmidt
goodman**
office products, Inc.

15221 N Broadway Ave
Rockwell, MN 55086
507.282.3570

CLIENT NAME
OLMCO

PROJECT TITLE
Layouts for Three
Venues

CLIENT CONTACT
Steven Flott
1581-10, Home Phone
Steven.McIntyre@olmco.com
sflott@gov

PROJECT ADDRESS
Rox. Healer
(Distributor, Address,
Distributor, Address,

SG PROJECT TEAM
Account Manager:
Alissa Wronbruder
Interior Designer:
CORSENI/O HCB

ALTERNATIVE
ALT. NAME:

REVISION LOG

NO.	DATE	DESCRIPTION
1	11/11/11	1
2	11/11/11	2
3	11/11/11	3
4	11/11/11	4
5	11/11/11	5

This document contains information that is the property of Schmidt Goodman and is provided for use only in your project. It is not to be reproduced, stored in a retrieval system, or used in any other manner without the written permission of SCOP.

Floral Hall

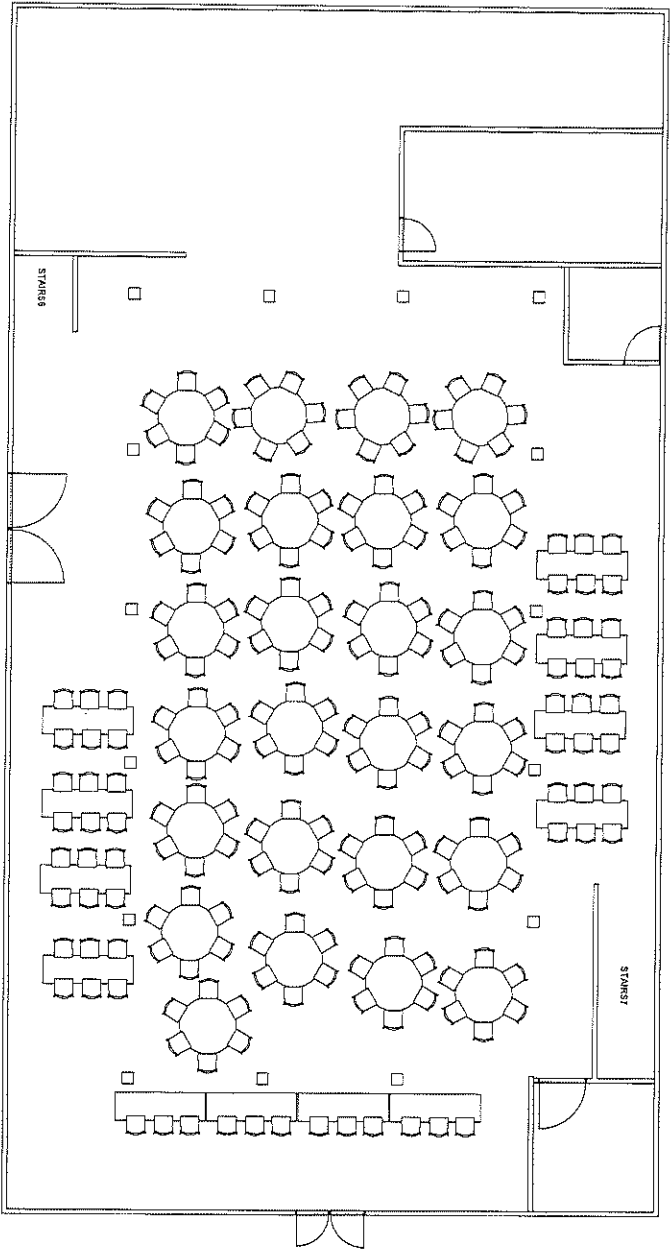

**schmidt
goodman**
office products, inc.

1420 N. Brookview Ave.
Rochester, MN 55916
507.252.8570

CLIENT NAME
OLMCO

PROJECT TITLE
Layouts for Hugo
Verdues

CLIENT CONTACT
Steven Frit

Steven.Frit@schmidtgo.com
507.252.8570

PROJECT ADDRESS
Rochester

SG PROJECT TEAM

Account Manager:
Alexei Vokobrubler
Interior Designer:
Christopher Hill

ALTERNATIVE

ALT. NAME

REVISION LOG

NO.	DATE	DESCRIPTION
1	10/20/2023	Initial layout
2	10/25/2023	Revised layout
3	11/01/2023	Final layout
4	11/05/2023	Revised layout
5	11/10/2023	Final layout

This document contains information considered proprietary to SCGP and is provided for use only in work to be performed for SCGP and shall not be used or reproduced or communicated in whole or in part to third parties without the written permission of SCGP.

Floral Hall

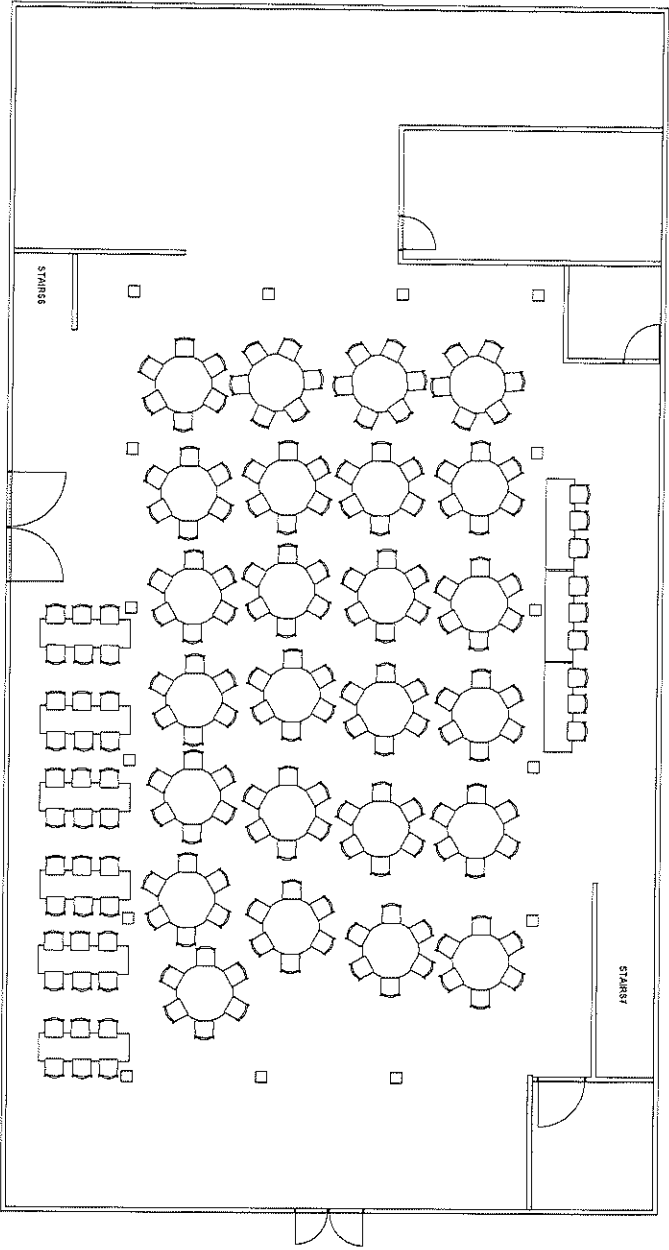

**schmidt
goodman**
office products, inc.

10201 N. Blackhawk Ave
Rockwell, PA 15086
507.262.8970

CLIENT NAME
OLMCO

PROJECT TITLE
Layout for Three
Venues

CLIENT CONTACT
Steven Fird

Steven.Mitch@olmco.com
olmco.com

PROJECT ADDRESS
Rockwell

SG PROJECT TEAM

Account Manager:
Alysa Wondolke
Interior Designer:
Cassandra Hill

ALTERNATIVE

ALT. NAME

REVISION LOG

NO.	DATE	DESCRIPTION
1.	1/2/2023	1
2.	1/2/2023	2
3.	1/2/2023	3
4.	1/2/2023	4
5.	1/2/2023	5

This document contains information considered proprietary to SGOP, and is provided for use only in work to be performed for SGOP and shall not be used or reproduced or communicated in whole or in part to third parties without the written permission of SGOP.

Floral Hall

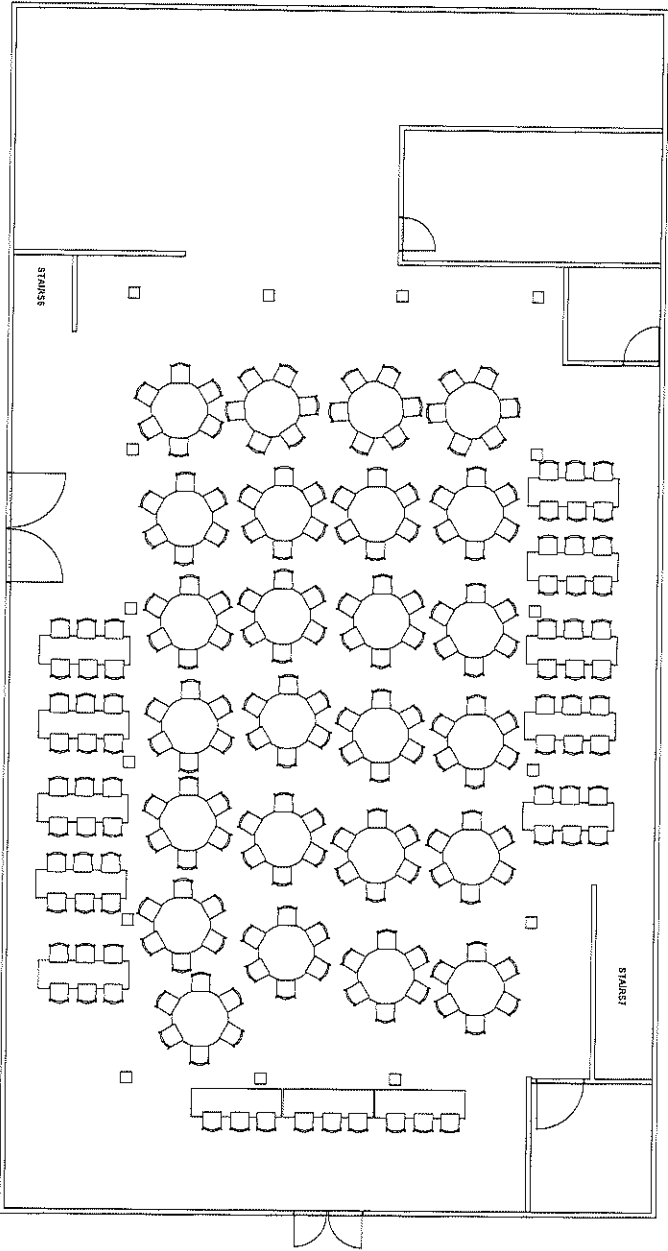

**schmidt
goodman**
office products, inc.

1928 N BROADWAY AVE
ROCHESTER, NH 05606
507.252.3570

CLIENT NAME
OLMCO

PROJECT TITLE
Layouts for these
venues

CLIENT CONTACT
Steven Fidd

steven.fidd@olmco.com
unity.gow

PROJECT ADDRESS
Rochester

SG PROJECT TEAM

Account Manager:
Alysa Vonderscherf
Interior Designer:
Cassandra Hoff

ALTERNATIVE

ALT. NAME

REVISION LOG

NO.	DATE	BY	DESCRIPTION
1	1/11/2023	AM	Initial layout
2	1/11/2023	AM	Revised layout
3	1/11/2023	AM	Final layout
4	1/11/2023	AM	Final layout
5	1/11/2023	AM	Final layout

This document contains information considered proprietary to SGCP, and is provided for use only in work to be performed by SGCP. It shall not be used or reproduced or otherwise disclosed in whole or in part to third parties without the written permission of SGCP.

Floral Hall

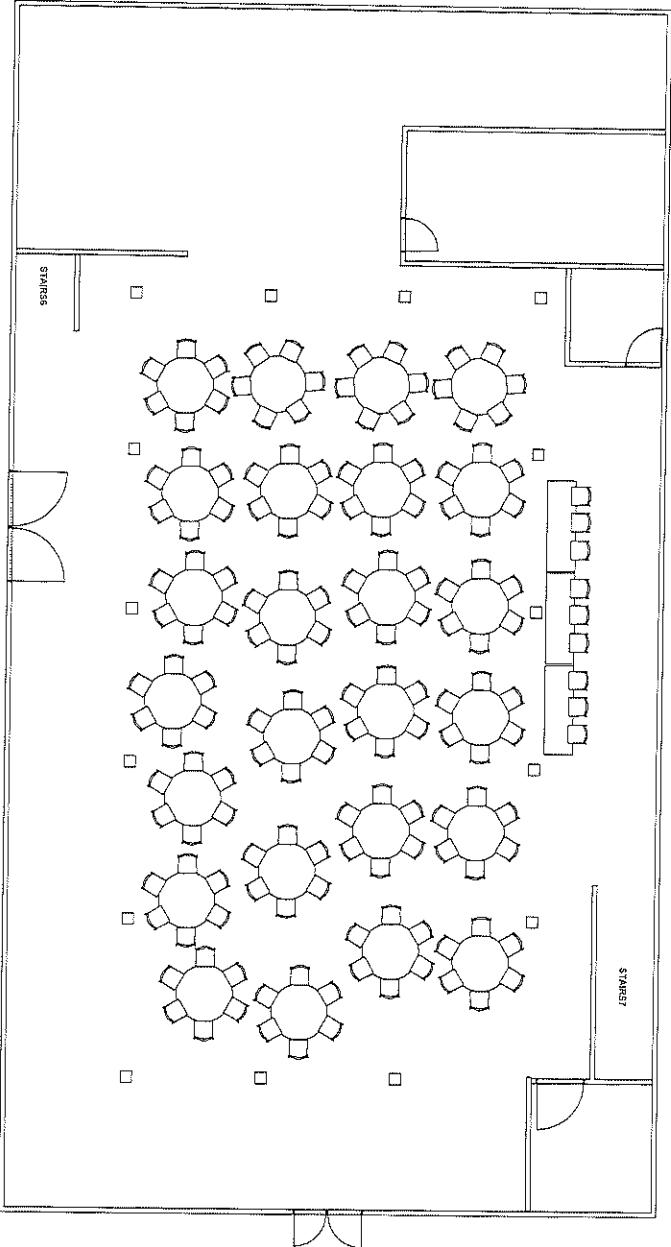

**schmidt
goodman**
office products, inc.

17281 N. Broadway Ave
Redwood City, CA 94065
507.202.3570

CLIENT NAME
OLMCO

PROJECT TITLE
Leopold for Bree
Venues

CLIENT CONTACT
Steven Finn

stevfin@olmco.com
unfy.gov

PROJECT ADDRESS
Rockefeller

SG PROJECT TEAM

Account Manager:
Alysa Winkler
Interior Designer:
Cassandra Hill

ALTERNATIVE

ALT. NAME

REVISION LOG

1.	LAKEVIEW	6.
2.		7.
3.		8.
4.		9.
5.		10.

This document contains information considered proprietary to SCGP, and is provided for use only in work to be performed for SCGP and shall not be used or reproduced or communicated in any form to third parties without the written permission of SCGP.

Floral Hall

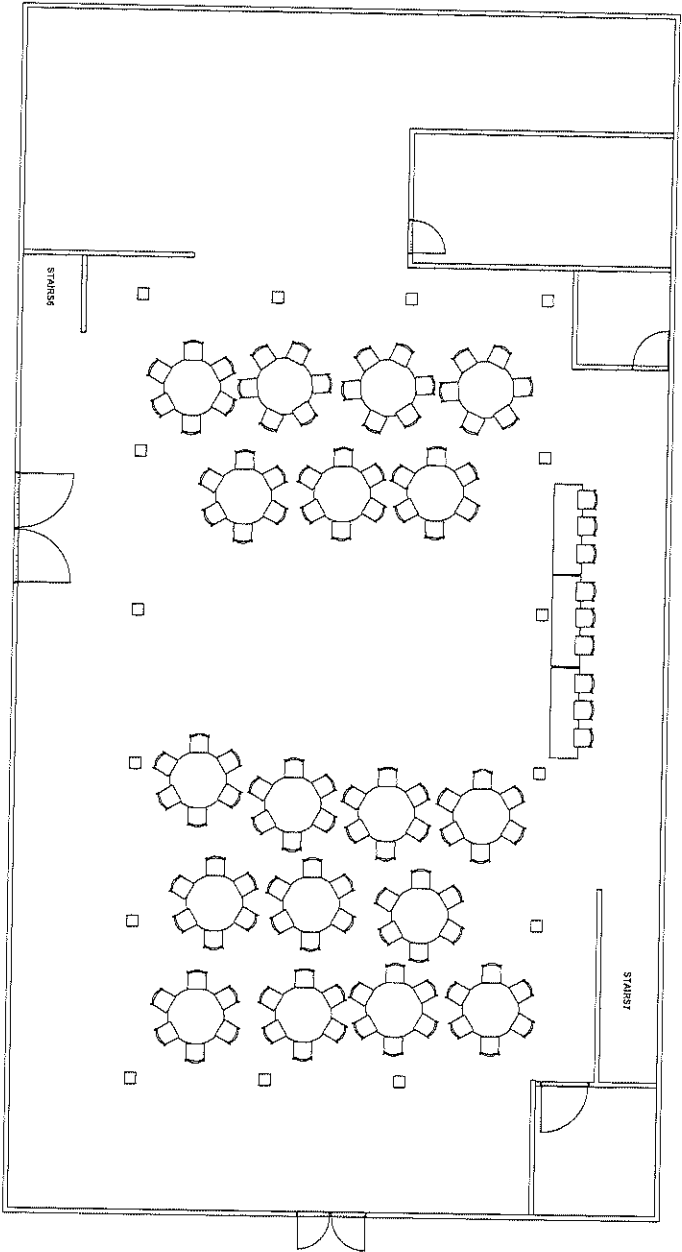

**schmidt
goodman**
office products, inc.

1926 N Broadway Ave
Rochester, NY 14615
507.282.8270

CLIENT NAME
OLMCO

PROJECT TITLE
Layouts for Three
Venues

CLIENT CONTACT
Shylen Fitch

Steven Elm & Associates
Unit 509V

PROJECT ADDRESS
Rochester

SG PROJECT TEAM
Account Manager:
Alicia Winkler
Interior Designer:
Cassandra Hill

ALTERNATIVE
ALL NAME

REVISION LOG

NO.	DESCRIPTION	DATE
1	AW	5/11
2	AW	5/11
3	AW	5/11
4	AW	5/11
5	AW	5/11

This document contains information considered proprietary to SCGP and is provided for use only in work to be performed by SCGP and shall not be used or reproduced or communicated in whole or in part to third parties without the written permission of SCGP.

Floral Hall

Example of 8 Chairs

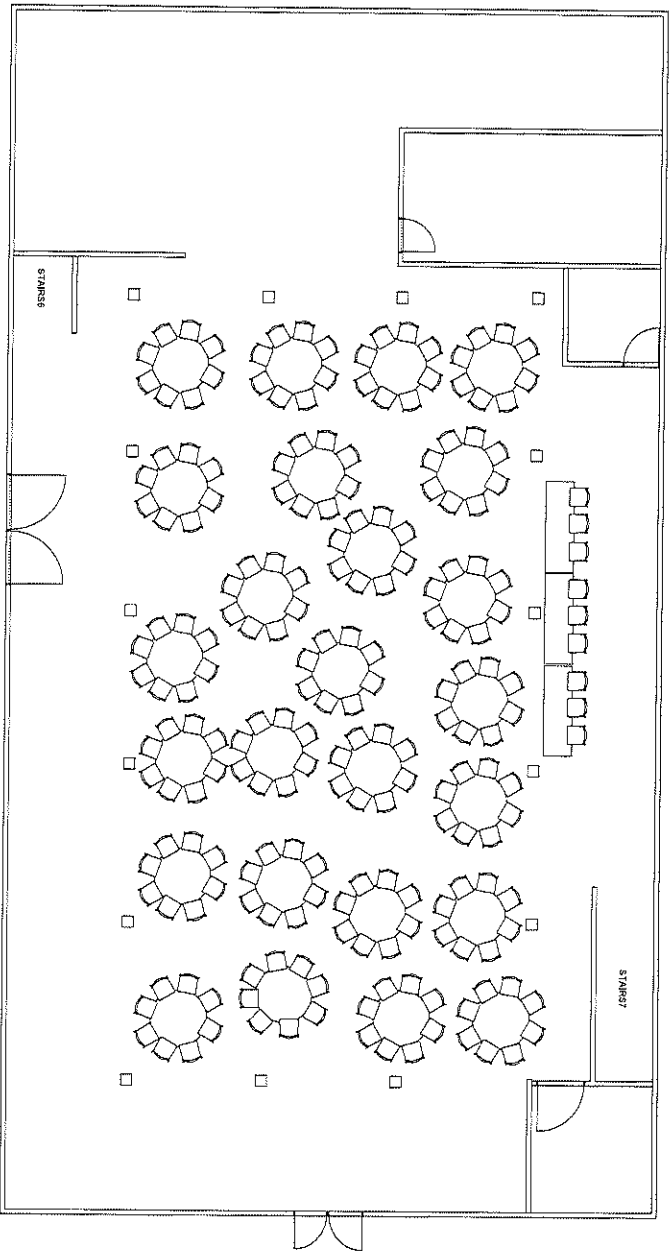

**schmidt
goodman**
office products, inc.

1720 N. BROADWAY AVE
RICHMOND, VA 23261
507.232.3970

CLIENT NAME
OLMCO

PROJECT TITLE
Layouts for Three
Venues

CLIENT CONTACT
Steven Finn

Steven.Finn@virginia.gov

PROJECT ADDRESS
Richfield

SG PROJECT TEAM

Account Manager:
Alysa Wunderscher
Interior Designer:
Cassandra Hill

ALTERNATIVE

ALT NAME

REVISION LOG

NO.	DATE	DESCRIPTION
1	1/22/2023	6
2	2/1/2023	7
3	2/1/2023	8
4	2/1/2023	9
5	2/1/2023	11

This document contains information considered proprietary to SCOP, and its use is restricted to SCOP. It is not to be used or reproduced or communicated in whole or in part to third parties without the written permission of SCOP.

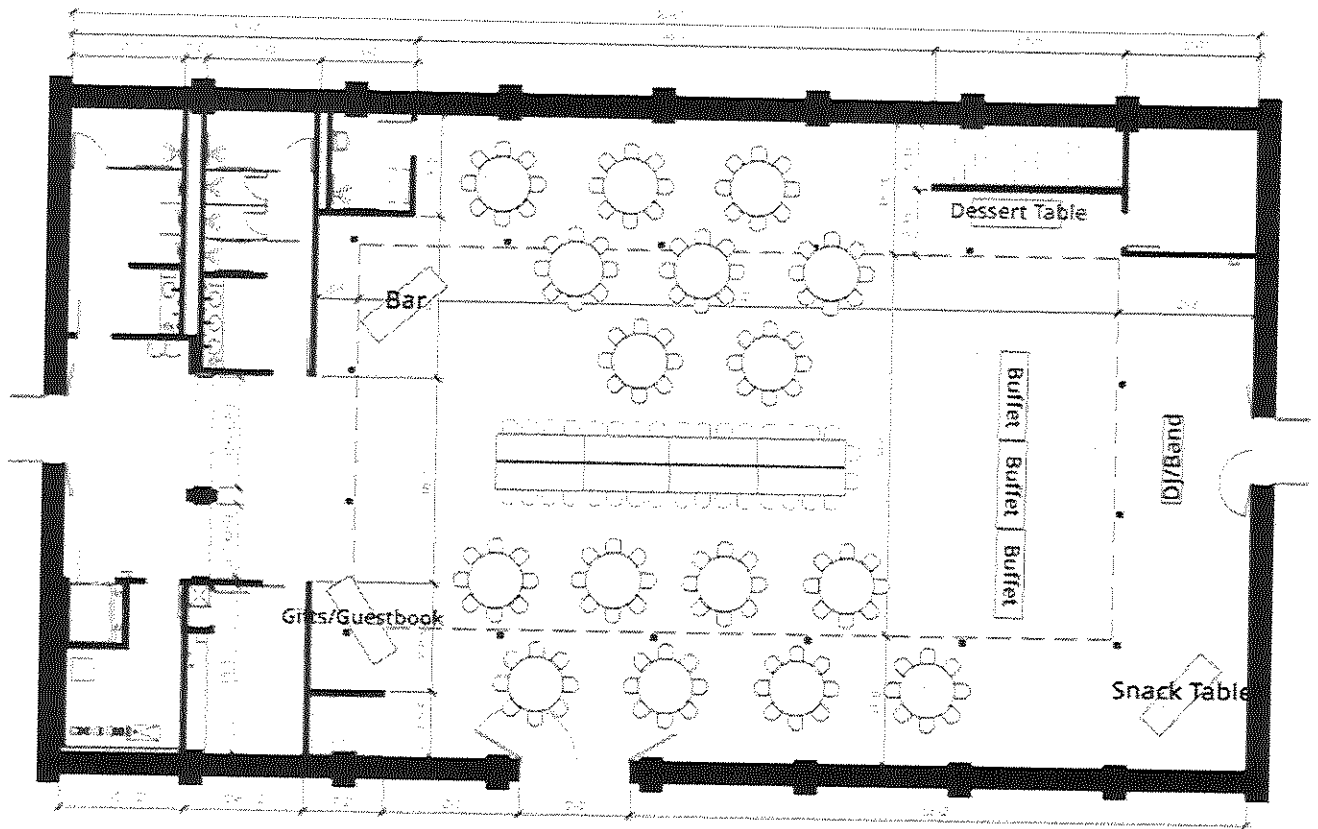

FIRST FLOOR PLAN
 SCALE: 1/8" = 1'-0"

